

eLink Pro

QUICK START GUIDE



For Video tutorials
www.elink-pro.tech/how-to

GETTING STARTED WITH ELINK-PRO

Elink is an automation tool for LinkedIn that makes use of Google's Chrome extension ecosystem to carry out LinkedIn processes on your behalf.

This quick start guide will help set up:

- Profile Viewing (800+ Per day)
- Connection Sending (50 per day)
- Follow Search (50 per day)
- Invite Messages
- Acceptance Messaging
- Automatic Connection request accept with a message
- Bulk Messaging to 1st Level Connections (70 per day)

DON'T FEEL LIKE READING?



SETTING UP YOUR ACCOUNT

Limits: Daily Viewing Limit

When it comes to LinkedIn, if there is one nugget of information that we can't express enough it is the fact that there are limits. These limits are there to prevent overuse and are referred to as commercial limits. We allow users to set their daily limit on view interactions with LinkedIn. Follow the steps below to set your Daily Viewing Limit. Not sure what a safe limit is? Here's an article to help you out.

[Learn More →](#)

1) Click Settings on the Side Menu

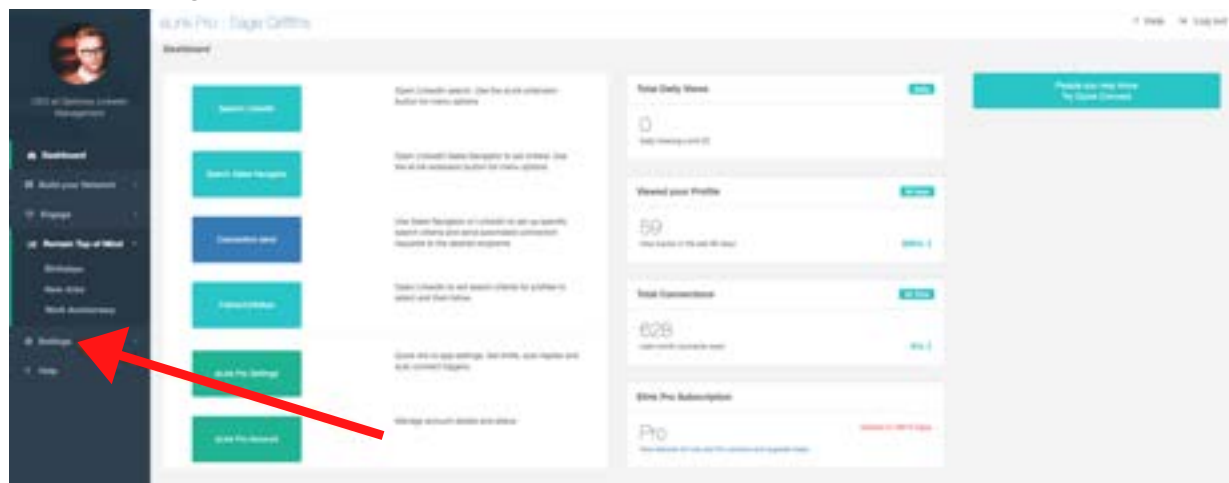

2) Click General on the Side Menu

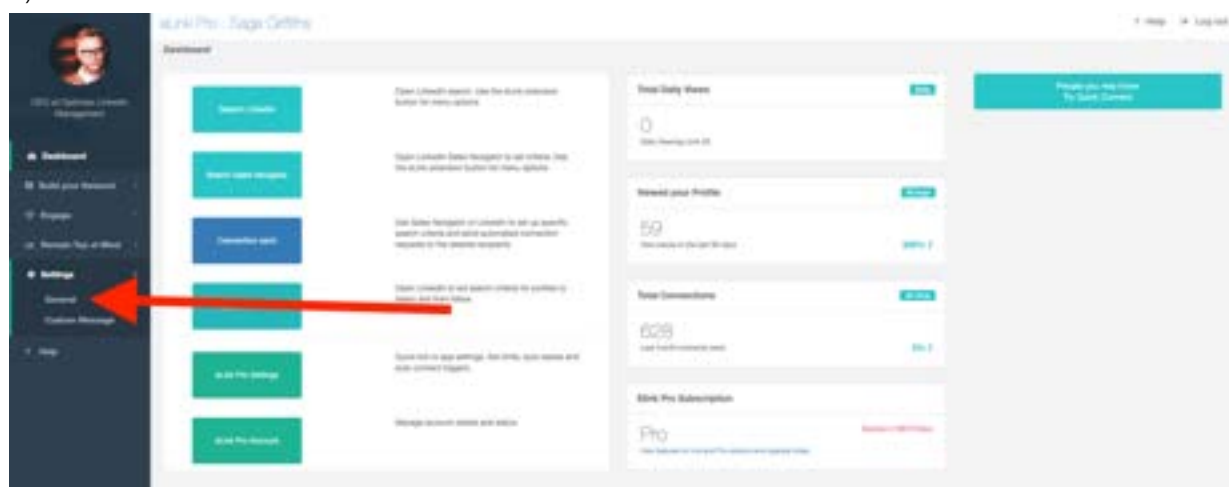

3) Set your daily profile viewing limit. We suggest 40 per day for non premium accounts and 800 per day for premium accounts.



SETTING UP YOUR ACCOUNT

Custom Messaging for Connection Send

Messaging is a very important part of starting a conversation with your prospects. Having a strong and engaging message when first engaging your prospect will result in much higher acceptance rates and in the same vein warms the client to further interactions in the future. The steps below will guide you on how to find and set up custom messaging.

1) Click Settings on the Side Menu



- “
- **Invite messages** - These messages are automatically added to your connection send searches.
 - **Acceptance messages**- These messages are sent out to all connections that accept your connection invites.
 - **Auto accept invites** - These messages are automatically sent out to all connection invites that you receive.
- ”

2) Click Custom Messaging on the Side Menu



- “
- Notable Suggestions**
- This message will go to all connections sent using eLink's Connection Send automation.
 - There is a character limit of 300 characters which is imposed by LinkedIn.
 - Ensure that "Click Send" is your preference for messaging.
- ”

3) Toggle the on/off button and then add the message that you would like to send to new connections. The blue buttons above the text box will inject the code to automatically insert the name for the user receiving the connection invite. This also works for surname and company.

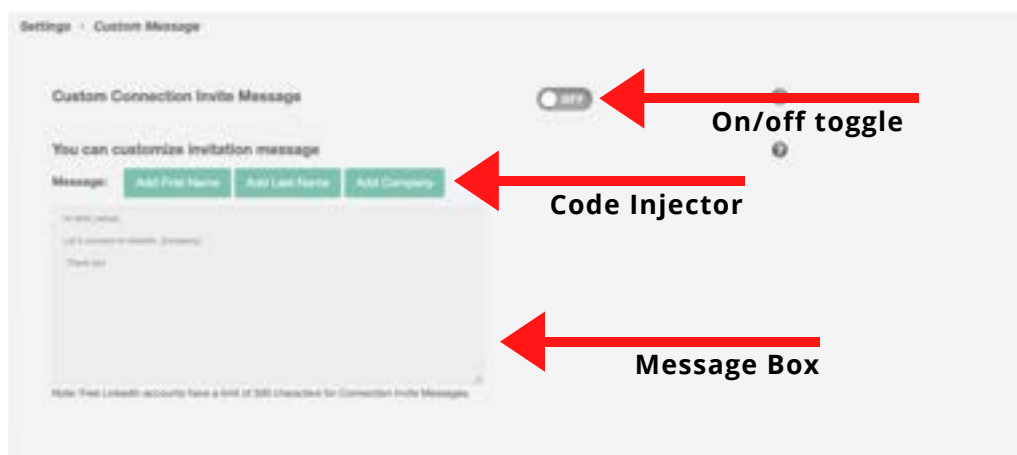

SETTING UP YOUR ACCOUNT

Messaging: Auto accept invite messages

Auto accept invite messages is a great feature that when used in conjunction with New Prospect Searches (see next page) can help build an effective method of first engaging with your connections. We suggest that you set eLink to do New Prospect Searches on your ideal target market, then in most cases, these individuals will either view you back or send you a connection request. This request will be automatically accepted and messaged using the feature below.

1) Click Settings then General on the Side Menu

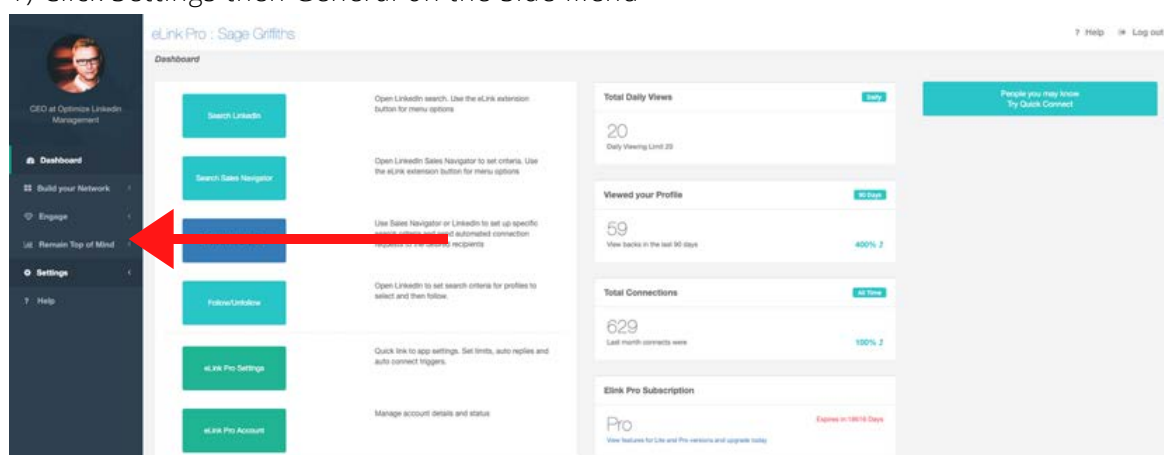

2) Set the toggle to on then select how many times per day you want eLink to check for new connection invites by adding a value of 1-3 with 3 being the max number of checks per day.

3) lastly add the body of your message into the text box and remember to click save at the bottom of the page.



Notable Suggestion

- While there is no limit on how long your autoaccept message can be - we suggest a short captivating message that engages your new connection

SETTING UP A SEARCH

New Prospect Search (Profile Viewing)

New Prospect Searches (Profile Viewing) is a great way to get your LinkedIn profile attention from targeted prospects. eLink has the power to automatically visit 800 profiles per day. While there is no guarantee that these people will turn around and visit your profile, there's a good chance that 5 to 10% will do so. Subsequently, 40+ people will check you out every day. Some will become connections and some may even qualify as a lead.

1) Click Search LinkedIn or Search Sales Navigator on the Dashboard

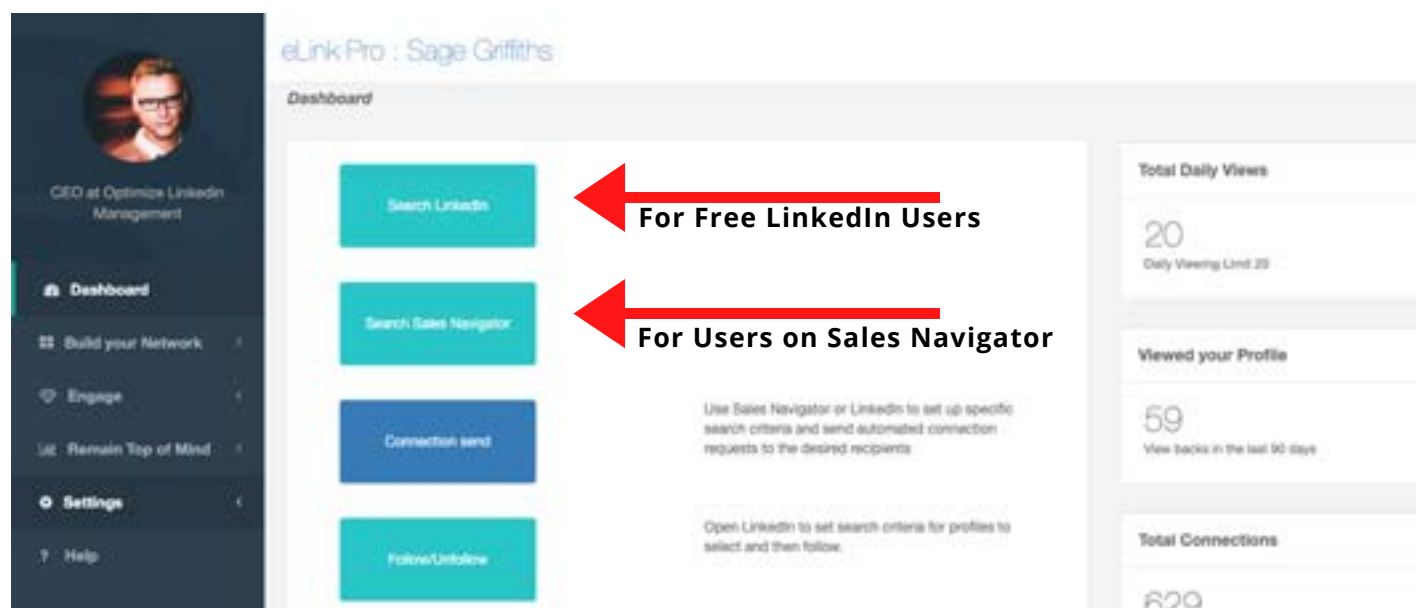

2) Set up Your LinkedIn Search (works the same with Sales Navigator)

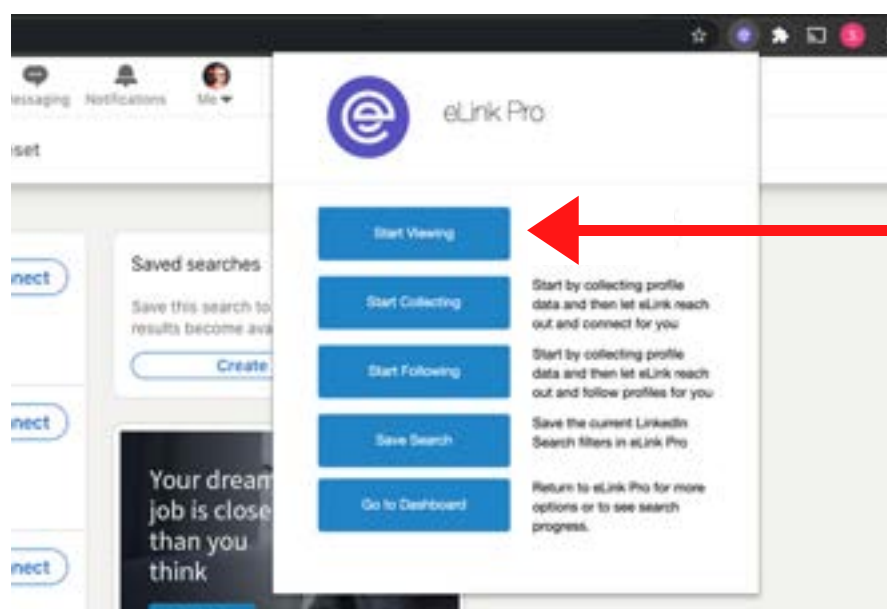
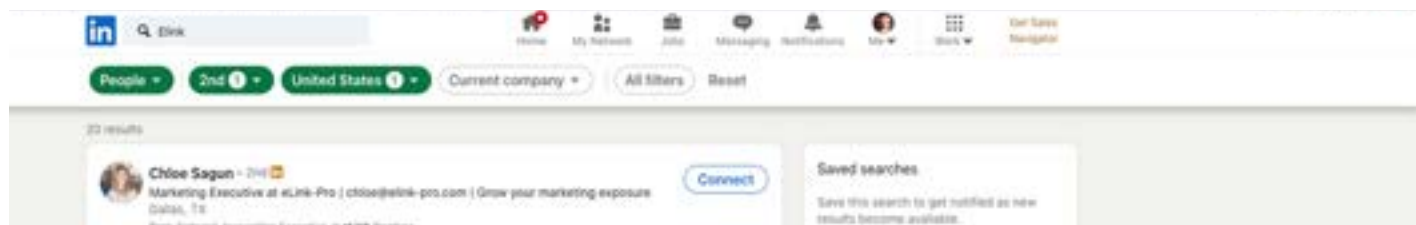

3) Click the purple eLink Icon on the top right hand corner.

- A drop down menu will open and present you with different options.
- To run a Profile View Search click '**Start Viewing**'. The search will then begin.
- **Leave the tab/window open** so that the search can run.
- You may **continue other tasks** on alternate tabs.
- **Do not use** your LinkedIn profile while automation is running as this will be seen as suspicious and in some cases you will be logged out of LinkedIn

SETTING UP A SEARCH

Connection Send (Connection Invites)

Connection Send Searches are a bit more of a active outreach feature, unlike profile viewing. Simply set up a target audience on LinkedIn and then send invites to connect at scale. Connection invites can be used with Custom messages set up on page 4. Remember that there is a limit of 300 characters on Connection Invites.

1) Click Connection Send on the Dashboard

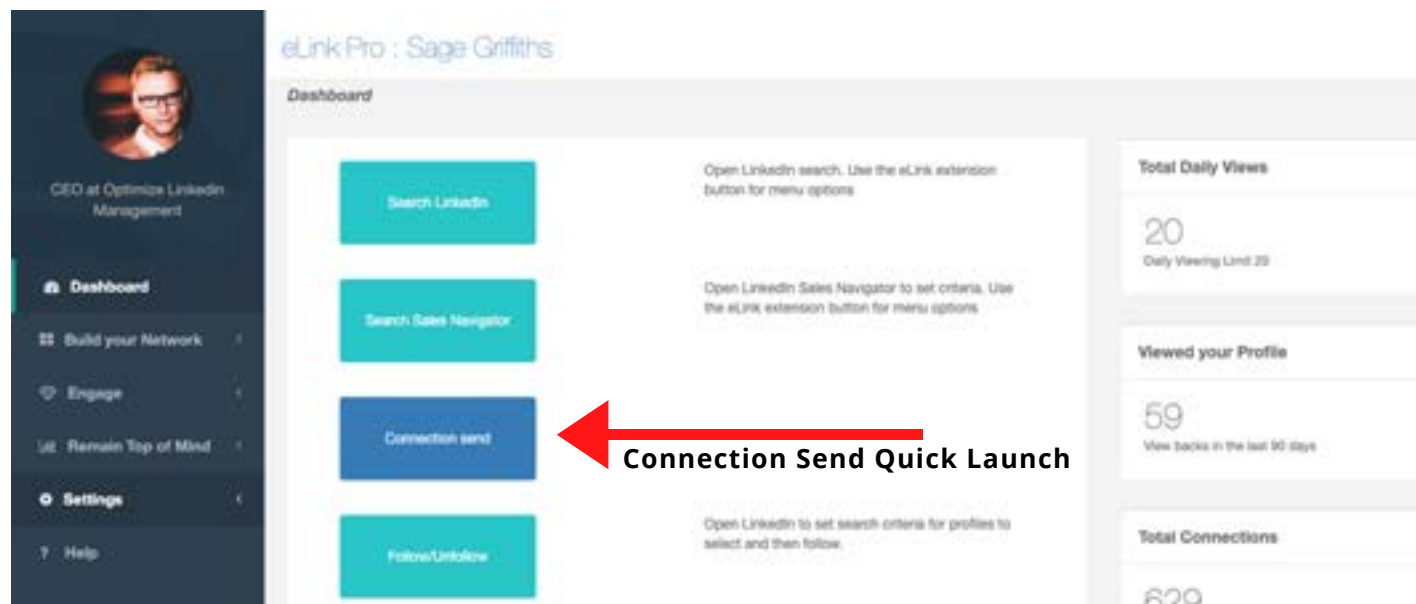

2) Set up Your LinkedIn Search (works the exactly same with Sales Navigator)

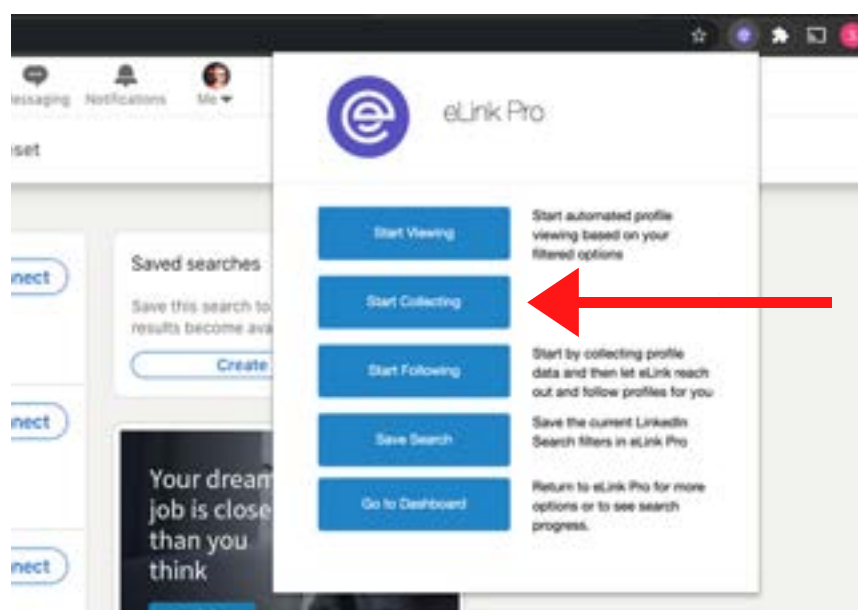
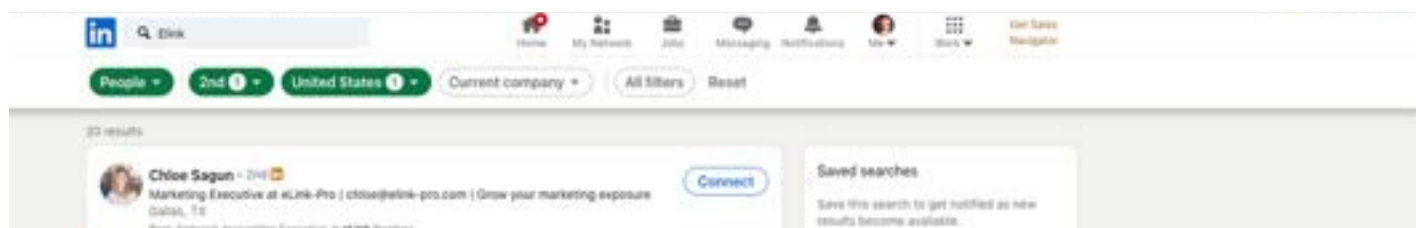

3) Click the purple eLink icon on the top right hand corner.

- To run a Connection Send Search click '**Start Collecting**'. The search will then begin collecting profiles to connect with.
- Once collecting is finished a pop up will appear asking to **start now** or **schedule** for a later stage.
- eLink will then run the search or start at the scheduled time doing **50 connection** requests **each day** till it hits the total amount of collected profiles.
- Searches **start automatically** each day at the same time that the first search was started or at the scheduled time.

MANAGING YOUR SEARCHES

Build Your Network Section

The Build Your Network section is where all active, paused and past searches are stored for New Prospect Searches (Profile Viewing), Connection Sends and Follows. Here you will be able to download the data and manage searches.

1) Click Build Your Network

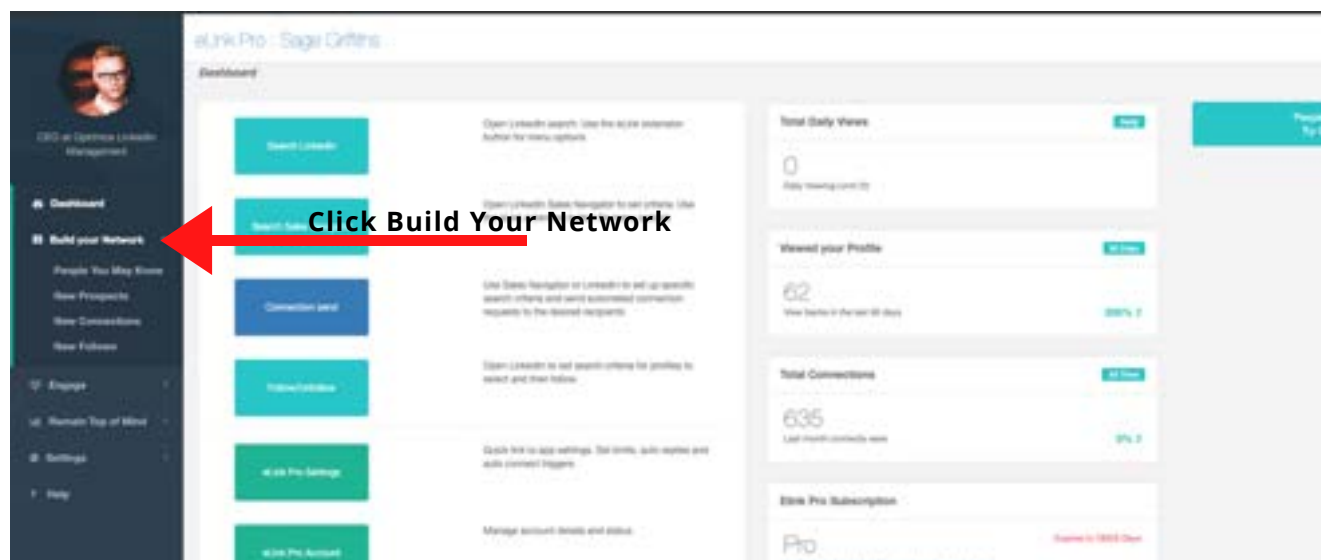

2) By clicking New Prospects, New Connections or New Follows you will see a search management dashboard that will allow you to quickly start, stop, pause, delete, schedule and download data for each search.

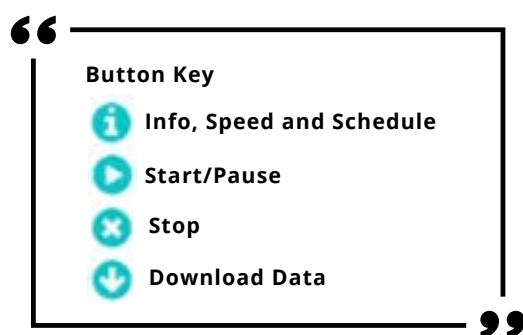
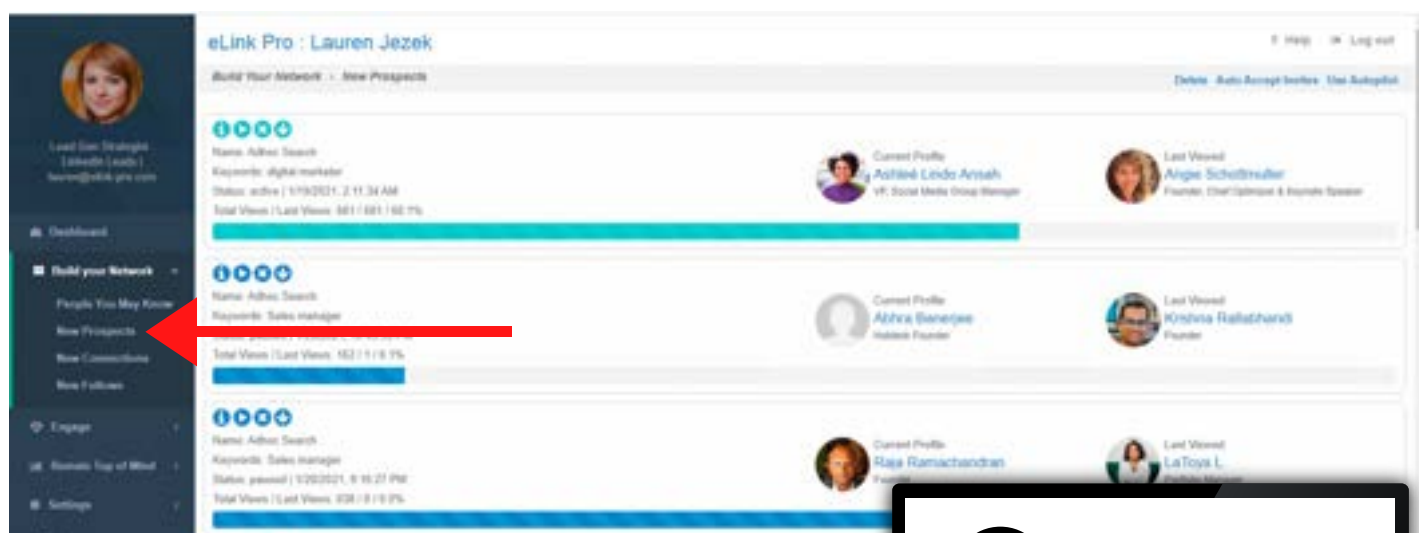

MESSAGING

Messaging to 1st Level Connections

Sending messages to your 1st level connections is a quick and easy way to engage the connections you already have. Simply set up a targeted search make sure you select 1st level connections and then send them a personalized message. The limits on messaging is between 30 and 70 per day. You can change this in the settings section under **Maximum Daily Views**

1) Set up your search to 1st level connections

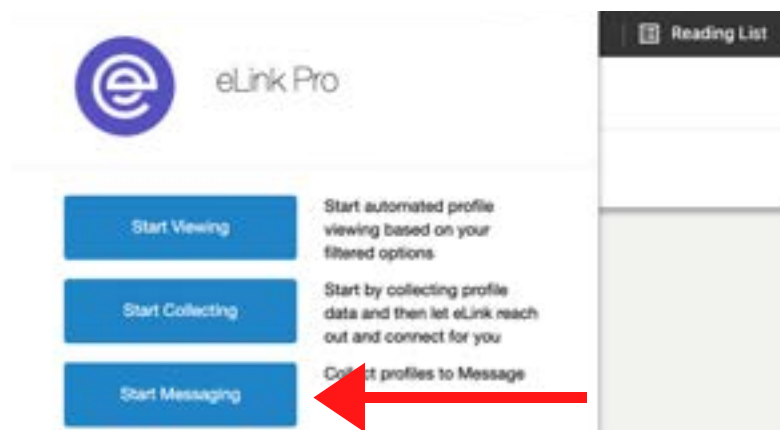
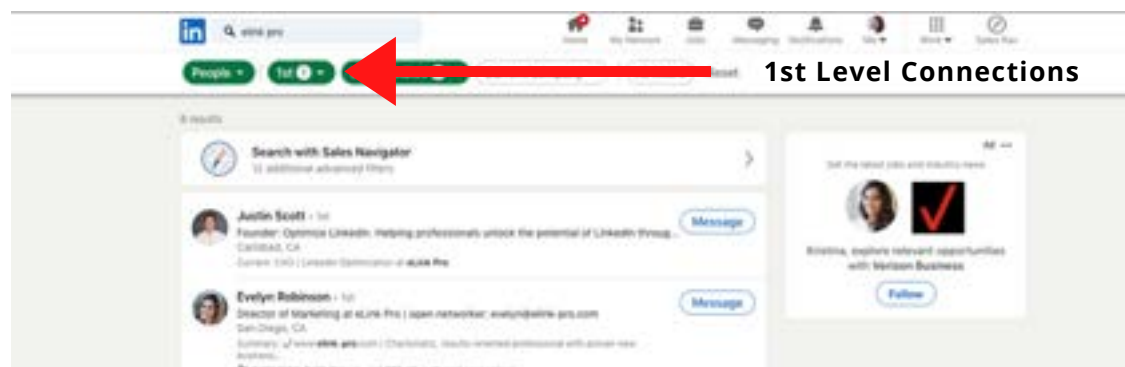

2) Click the purple eLink icon on the top right hand corner.

- To run a Messaging Campaign click '**Start Messaging**'. The search will then begin collecting profiles to Message.
- Once collecting is finished the screen will change to the new '**Messaging Dashboard**'

3) The Messaging Dashboard

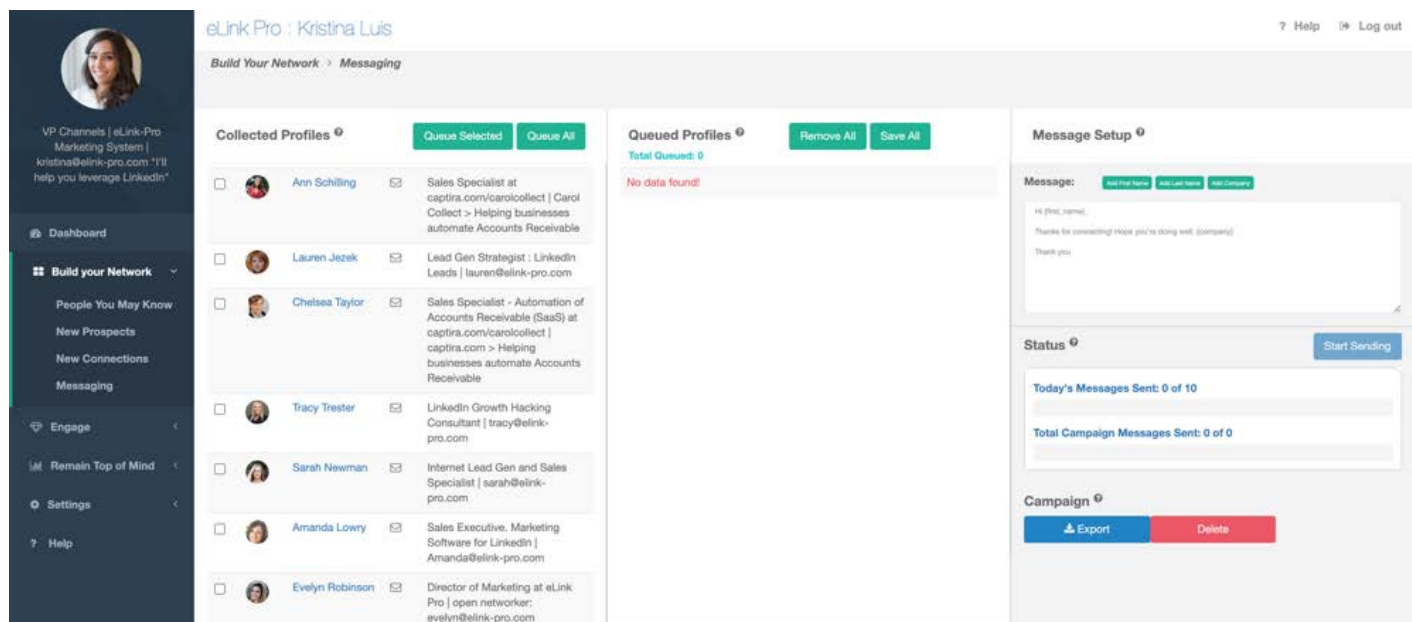

MESSAGING

Messaging to 1st Level Connections

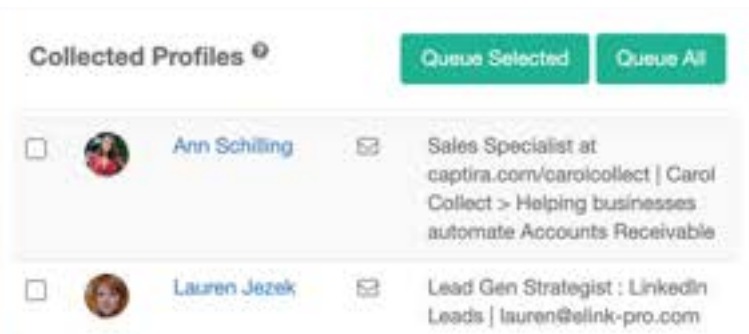

4) **Select** the profiles that you would like to message or simply click the **Queue All**

The  Icon indicates that you have messaged the user before. By clicking the icon you will be able to see the message history.

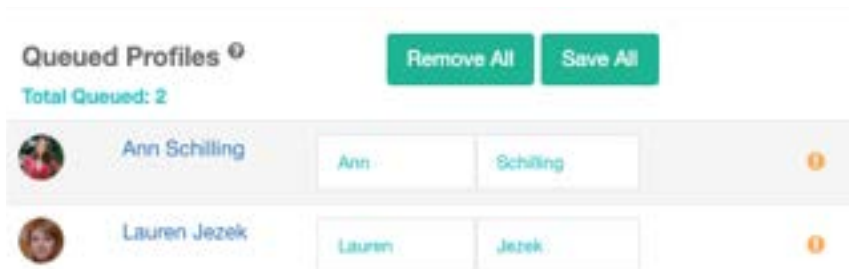

5) **Profiles** will then be moved from the collected section to **Queued Profiles**. Here name alterations and changes can be made.

Once done clicking **Save** or the **Save All** button will complete your queue.



6) Set up your **Message**. The First Name, Last Name and Company injectors work just as they do in **Custom Messaging**.

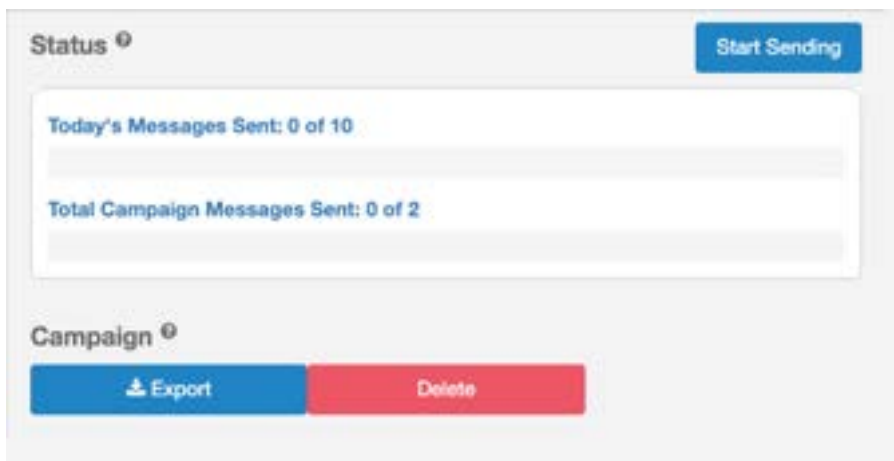

7) Lastly Click **Start Sending** and the campaign will begin.

Some things to remember:

- Elink will send **30-70** messages per day
- The message campaign will need to be **manually started each day**.
- Clicking the **Delete** button will remove the entire campaign
- Clicking **Export** will export the profiles that received messages